

ANEXA NR. 2

PLAN DE AMPLASAMENT SI DELIMITARE A IMOBILULUI
cu propunere de dezmembrare scara 1:2000

Nr. cadastral	Suprafata masurata	Adresa imobilului	
971	106328 mp	Str. Dr.Victor Babes, nr.2	
Cartea funciara nr.	720/N	UAT	Tarnaveni

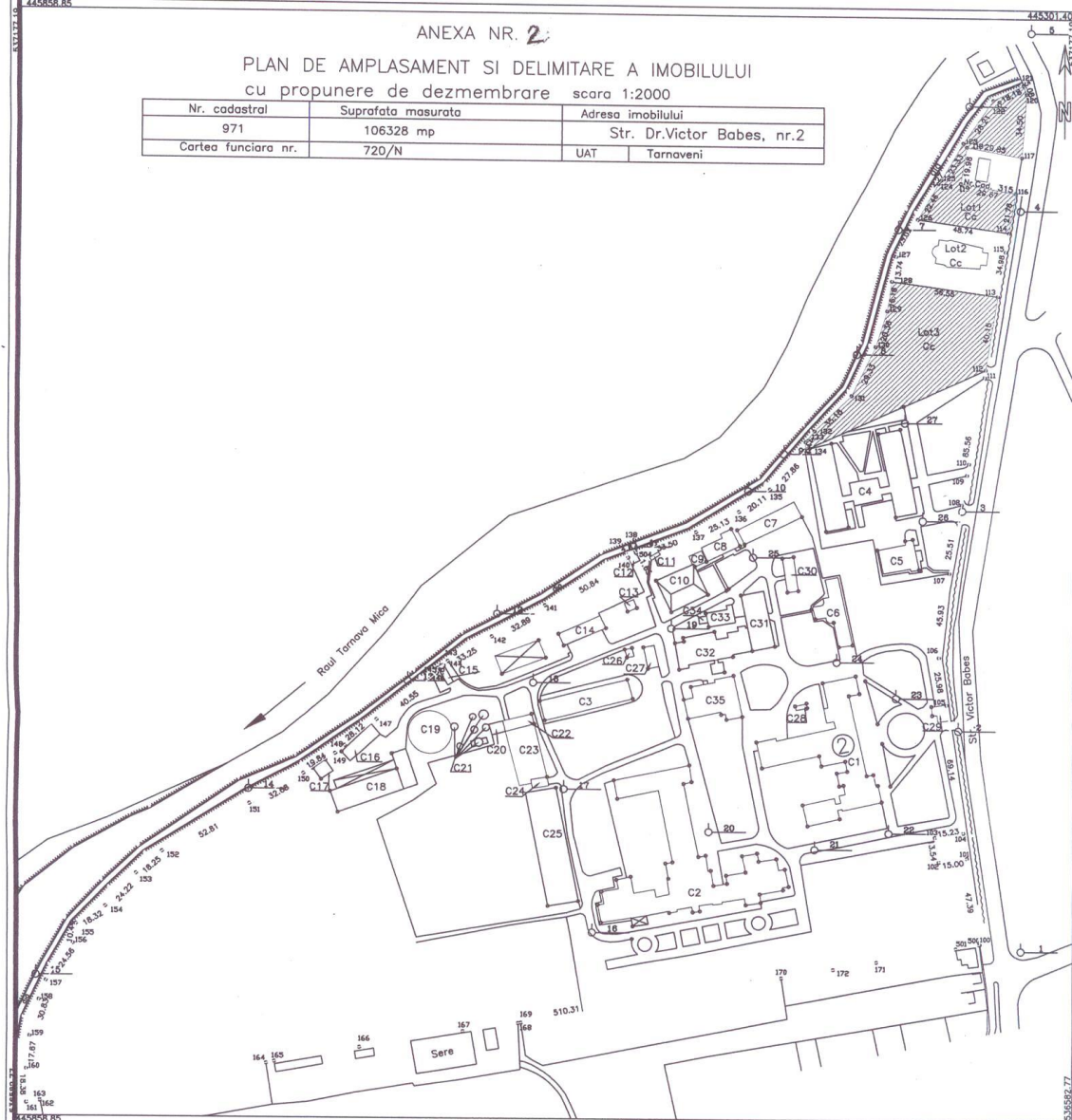

Situatia actuala (inainte de dezlipire)				Situatia viitoare (dupa dezlipire)			
Nr. Cad./Nr.Top.	Suprafata (mp)	Categoria de folosinta	Descrierea imobilului	Nr. cad.	Suprafata (mp)	Categoria de folosinta	Descrierea imobilului
Nr.Cad:971	106328	1Cc	curti constructii intravilan	971/1	1940	Cc	teren curti constructii intravilan
Nr.Top:2035/2,2036/2,2037/2				971/2	1900	Cc	teren curti constructii intravilan
2034/2,2032/1/2,2032/2/2/2				971/3	102488	Cc	teren curti constructii intravilan
2033/2, 2031/2, 2039/2,				Total	106328		
2040/1/2, 2041/2,2042/2							
2043/2,2038/1/2							

Data:21.01.2014

Executant
ing. Luta Lucide

The text includes the name of the architect, 'ing. Luta Lucide', and several official stamps. One stamp is from the 'CASA DE PROIECTARE SI INTERMEDIERI' (Design and Intermediary House) in Tarnaveni. Another stamp is from the 'LUTA LUCIDE' company, which is a limited liability company (SRL) registered in Tarnaveni.